

DRAINAGE EASEMENT

N 89° 04' 35" E 986.12'

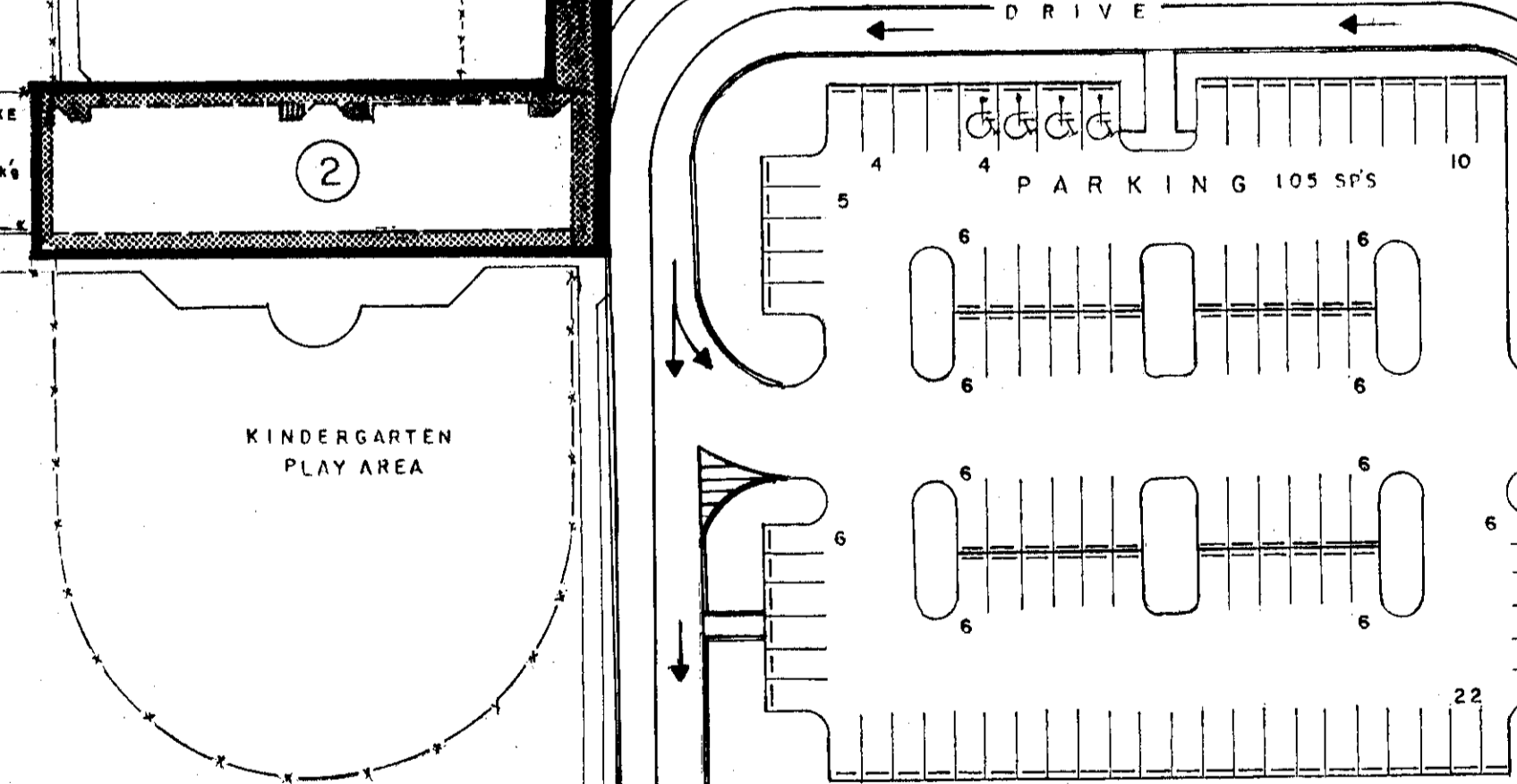
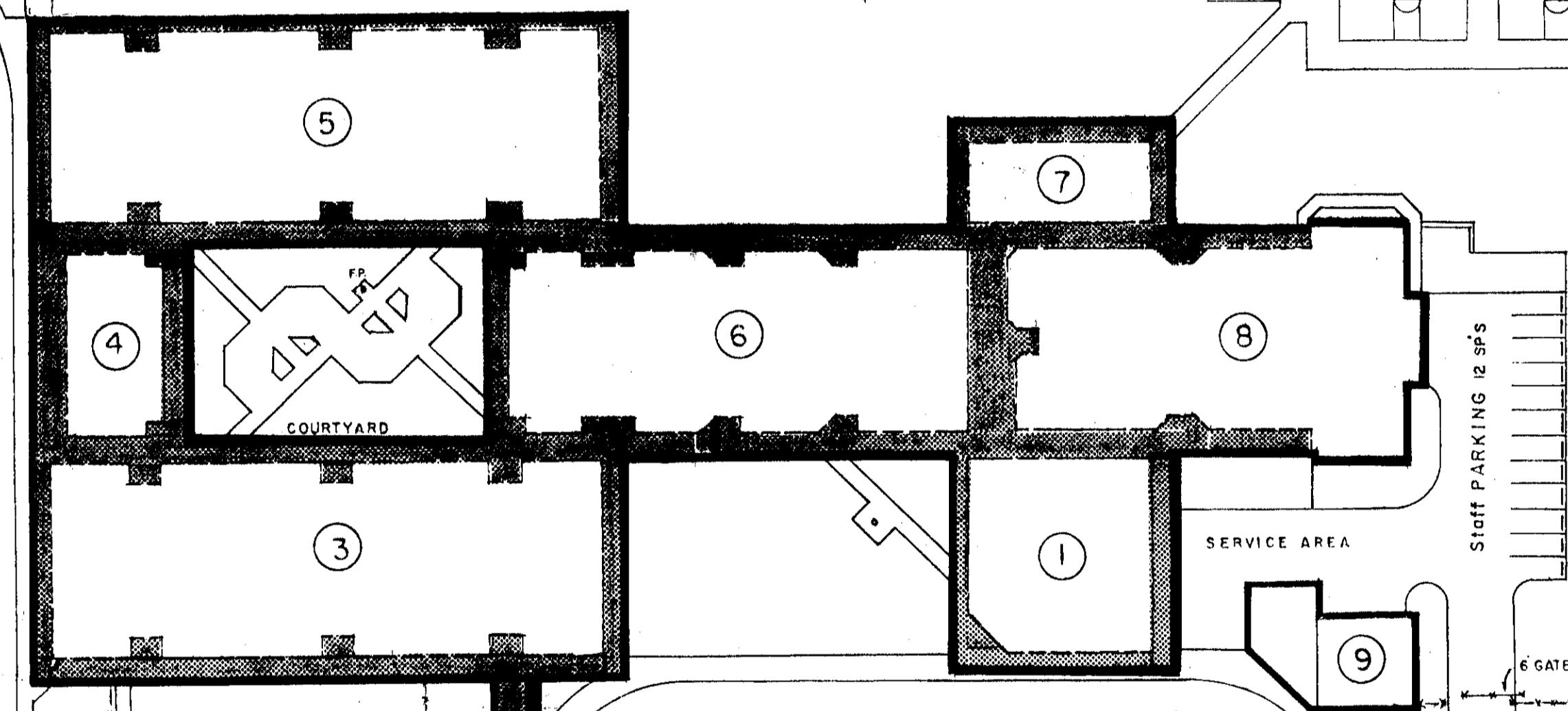
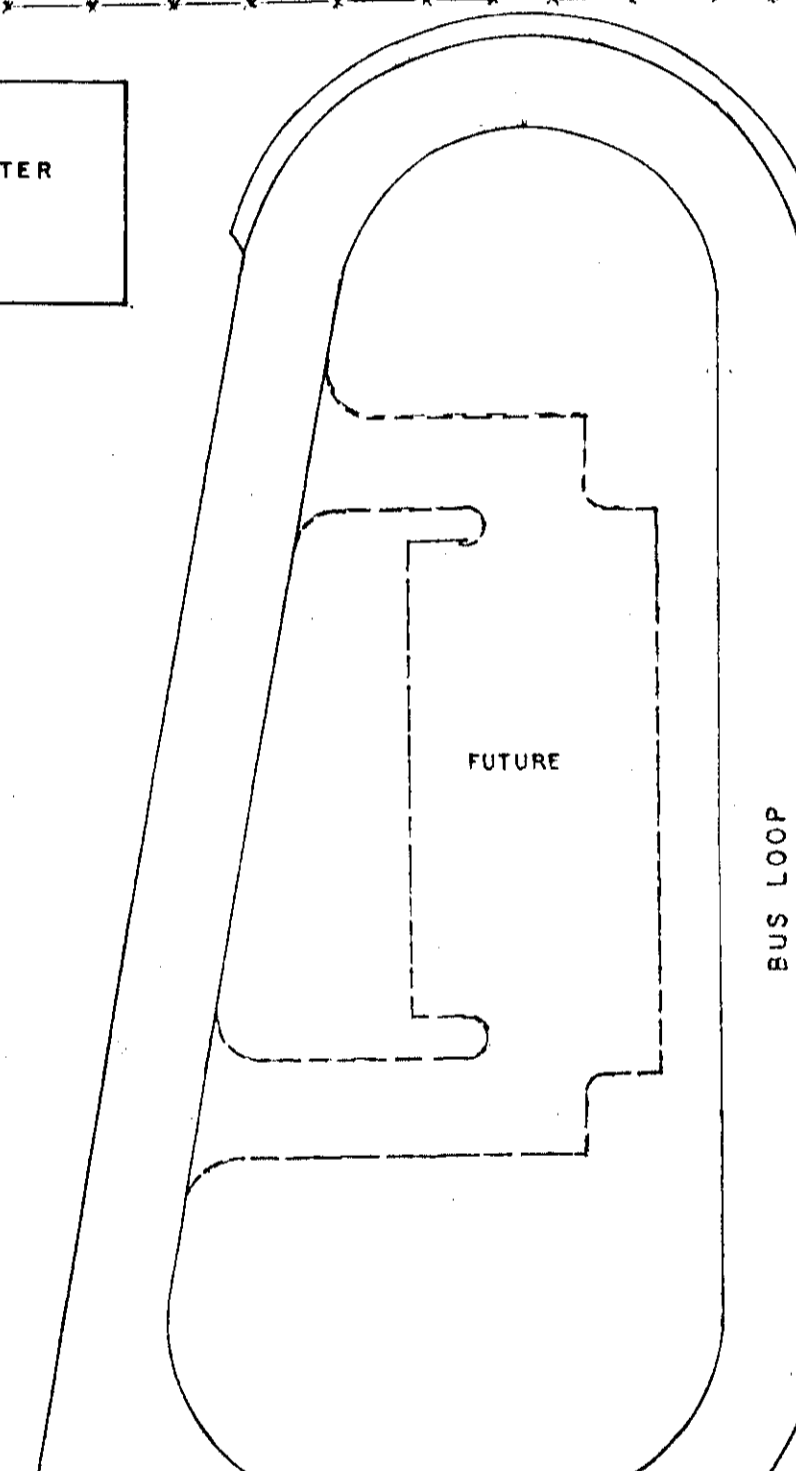
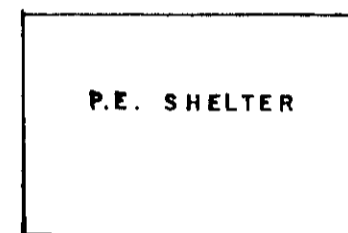
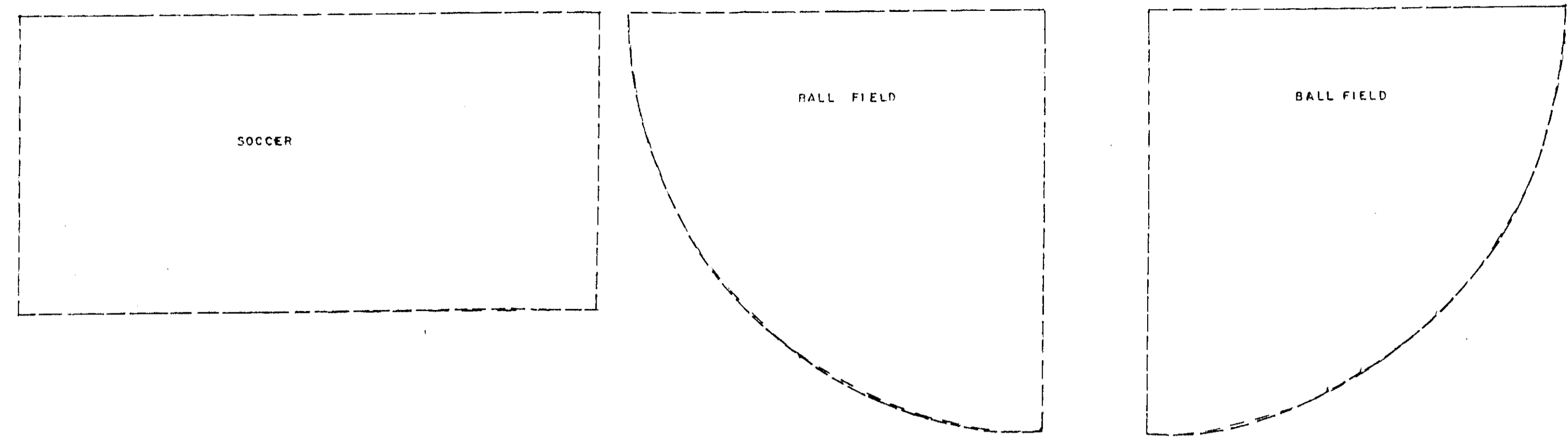

N 00° 55' 25" W 895.73'

S 00° 54' 31" E 825.27'

N 89° 46' 33" E 330.16'

R=26.40'

Δ=13° 49' 08" ARC = 630.72'

GLADES RD.

F.P.L. EASEMENT

- BLDG.
- 1 ADMINISTRATION
 - 2 KINDERGARTEN CL. RMS
 - 3 CLASSROOMS
 - 4 SKILL DEV. LABS
 - 5 CLASSROOMS
 - 6 LIBRARY
 - 7 MUSIC
 - 8 CAFETERIUM
 - 9 COOLING TOWER

LEGEND

- ④ BUILDING NUMBER
- ⑩① ROOM NUMBER WITH STUDENT STATIONS
- 117 ROOM NUMBER
- A ROOM NUMBER SUFFIX TO ADJACENT RM.
- COVERED WALKWAYS
- INTERIOR CIRCULATION
- PROPERTY LINE
- FENCE
- PROPERTY MARKER



SCALE 1" = 50'-0"

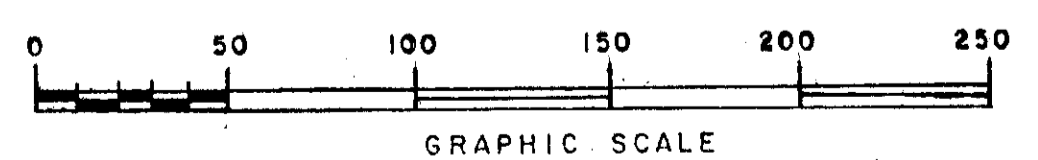

ADMIN. NO.	1961
PARCEL NO.	196
PARCEL ACREAGE TOTAL	20
TOTAL PARKING SPACES	117

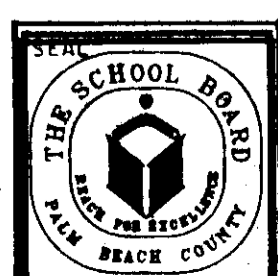
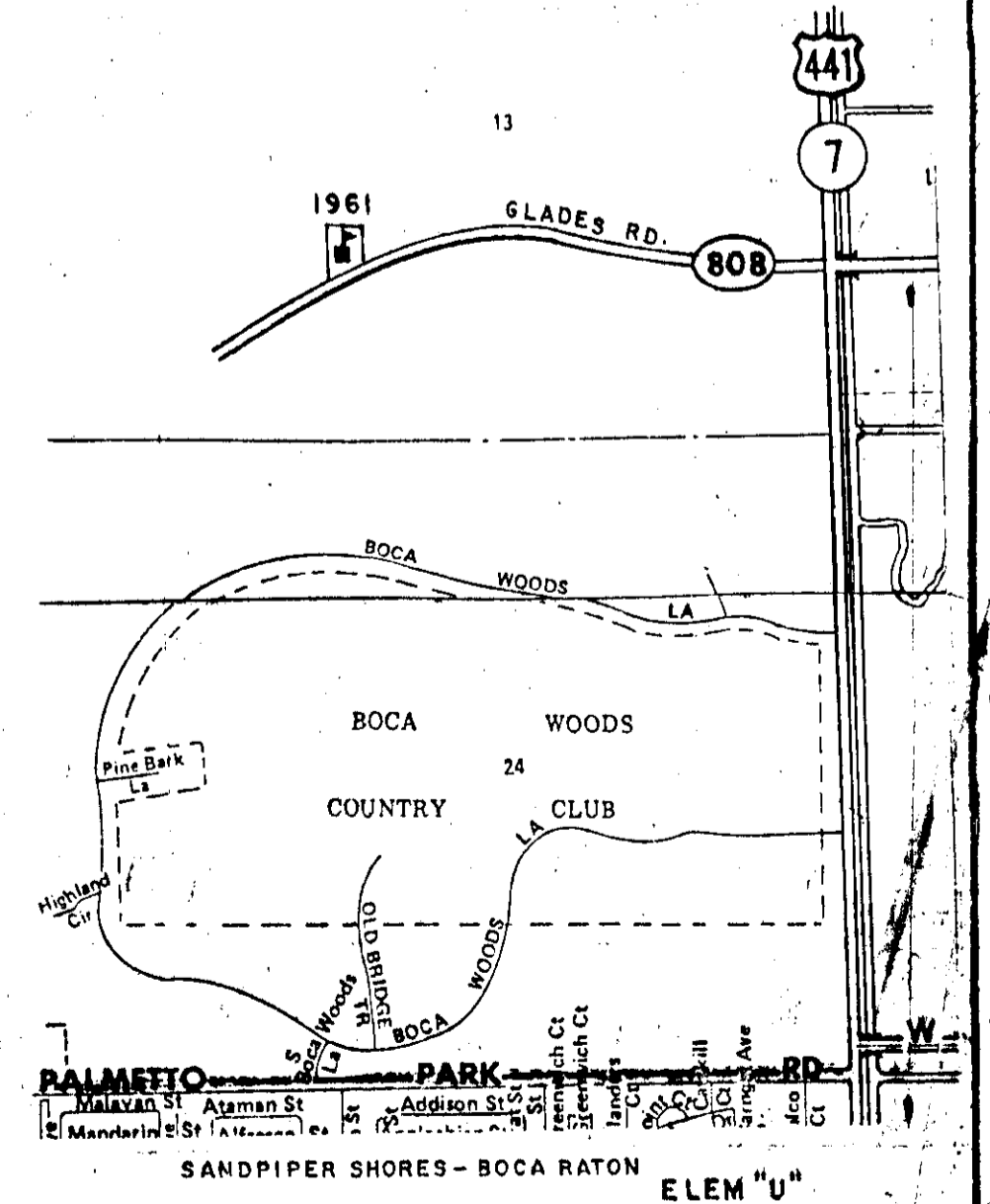

REVISIONS	DATE
ADDED NEW ACCESS DRIVE TO PARKING LOT - 3-27-81	1-7-89
POW	DRWN BY J.W.
CHKD BY	

THE SCHOOL BOARD OF
PALM BEACH COUNTY, FLORIDA
FACILITY DESIGN
ARCHITECT

TITLE
MASTER SITE PLAN

SCHOOL
**SANDPIPER SHORES
ELEMENTARY**
1961 BOCA RATON

SHEET
1
2
JOB NO.
223