

DRAINAGE EASEMENT

N 89° 04' 35" E 986.12'

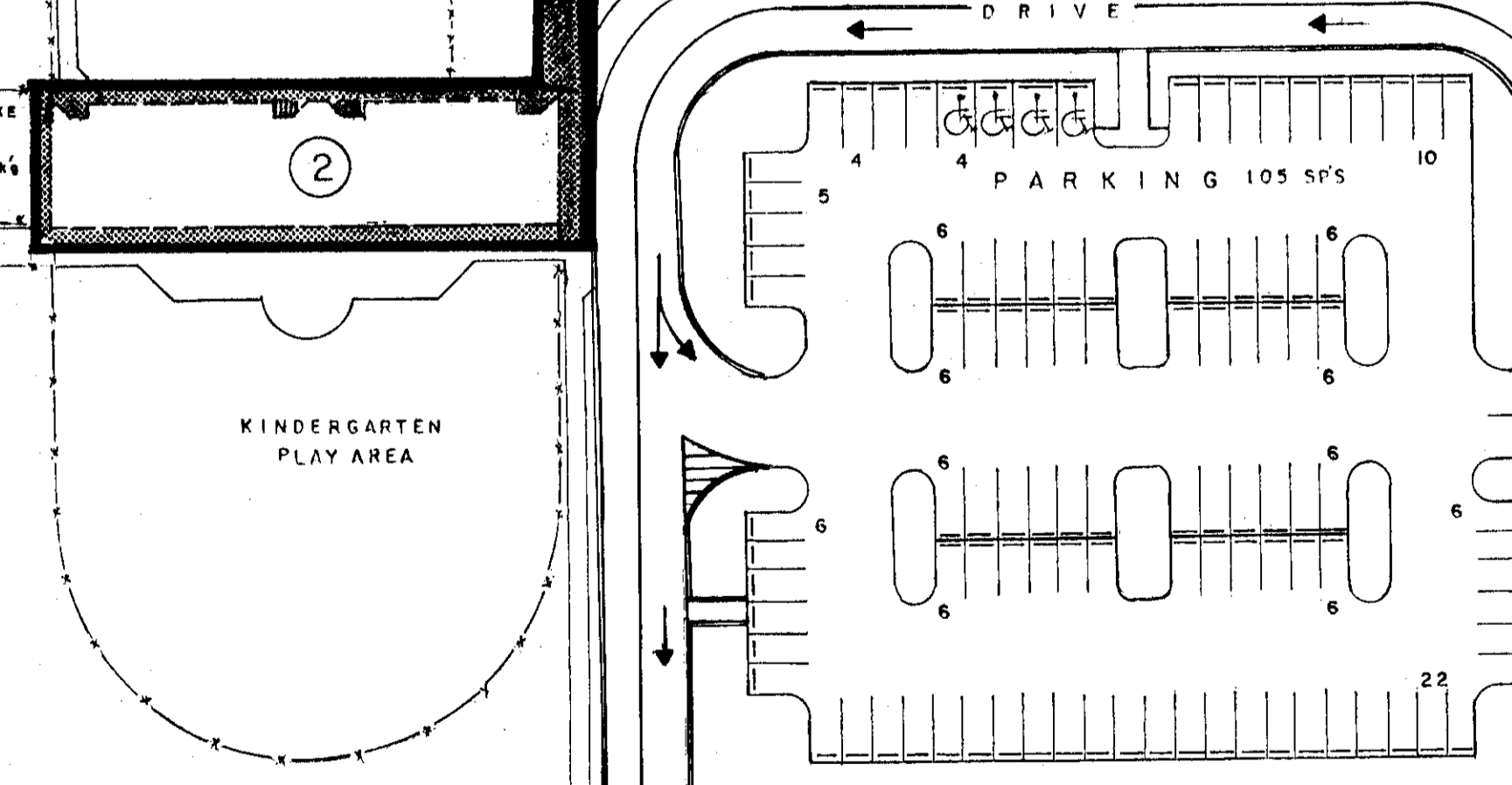
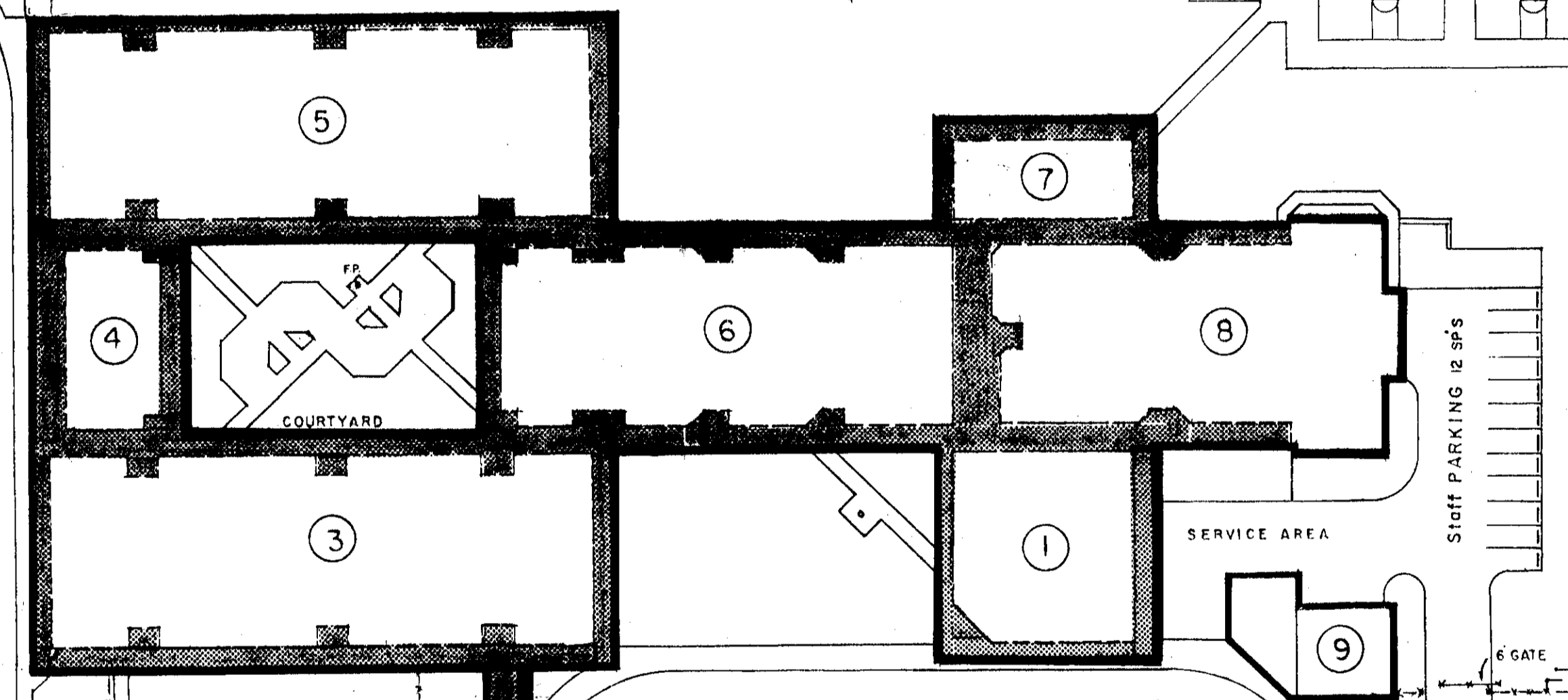
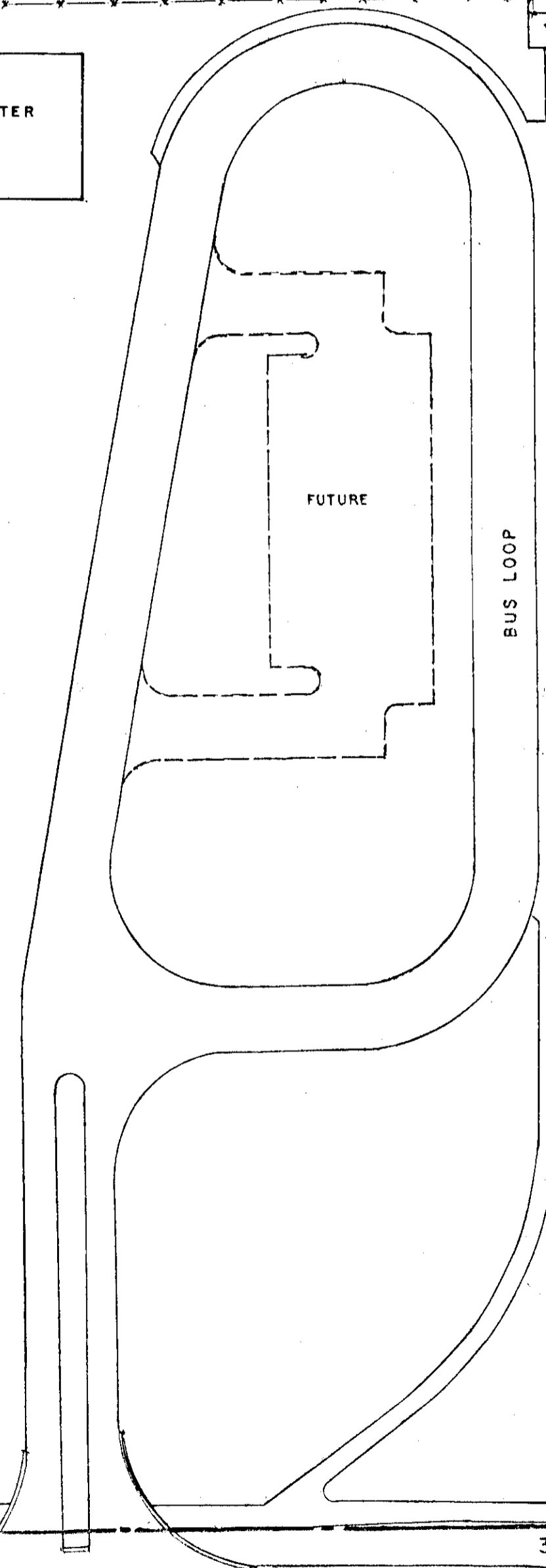
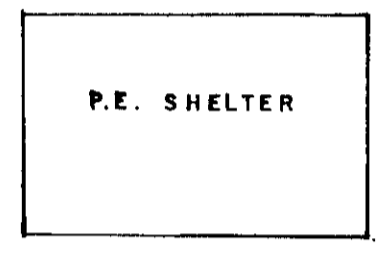
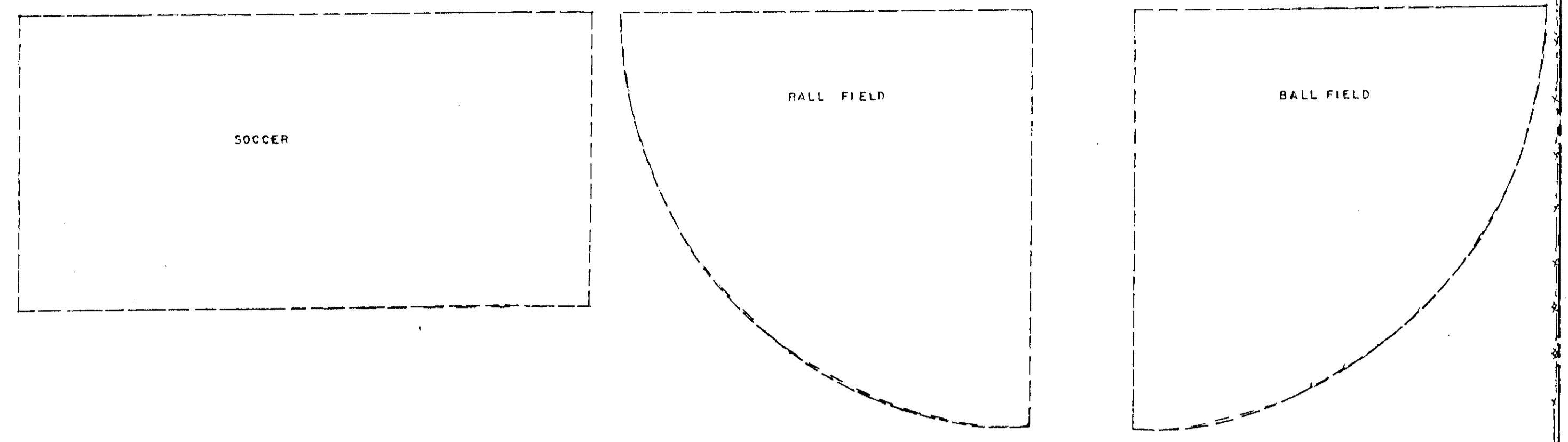

IRRIGATION PUMP
S 00° 54' 31" E 825.27'

N 00° 55' 25" W 895.73'

Landscape Easement

N 89° 46' 33" E 330.16'

R=26.40'

Δ=13° 49' 08" ARC = 630.72'

GLADES RD.

F.P.L. EASEMENT

- BLDG.**
- 1 ADMINISTRATION
 - 2 KINDERGARTEN CL.RMS
 - 3 CLASSROOMS
 - 4 SKILL DEV. LABS
 - 5 CLASSROOMS
 - 6 LIBRARY
 - 7 MUSIC
 - 8 CAFETERIUM
 - 9 COOLING TOWER

LEGEND

- ④ BUILDING NUMBER
- ①01 ROOM NUMBER WITH STUDENT STATIONS
- 117 ROOM NUMBER
- A ROOM NUMBER SUFFIX TO ADJACENT RM.
- COVERED WALKWAYS
- INTERIOR CIRCULATION
- PROPERTY LINE
- FENCE
- PROPERTY MARKER

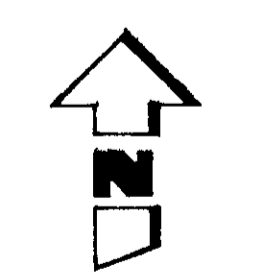

SCALE 1" = 50'-0"

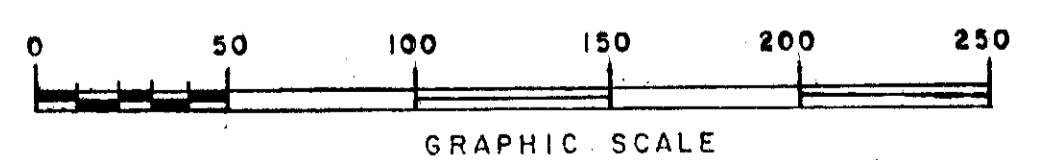

ADMIN. NO.	1961
PARCEL NO.	196
PARCEL ACREAGE TOTAL	20
TOTAL PARKING SPACES	117

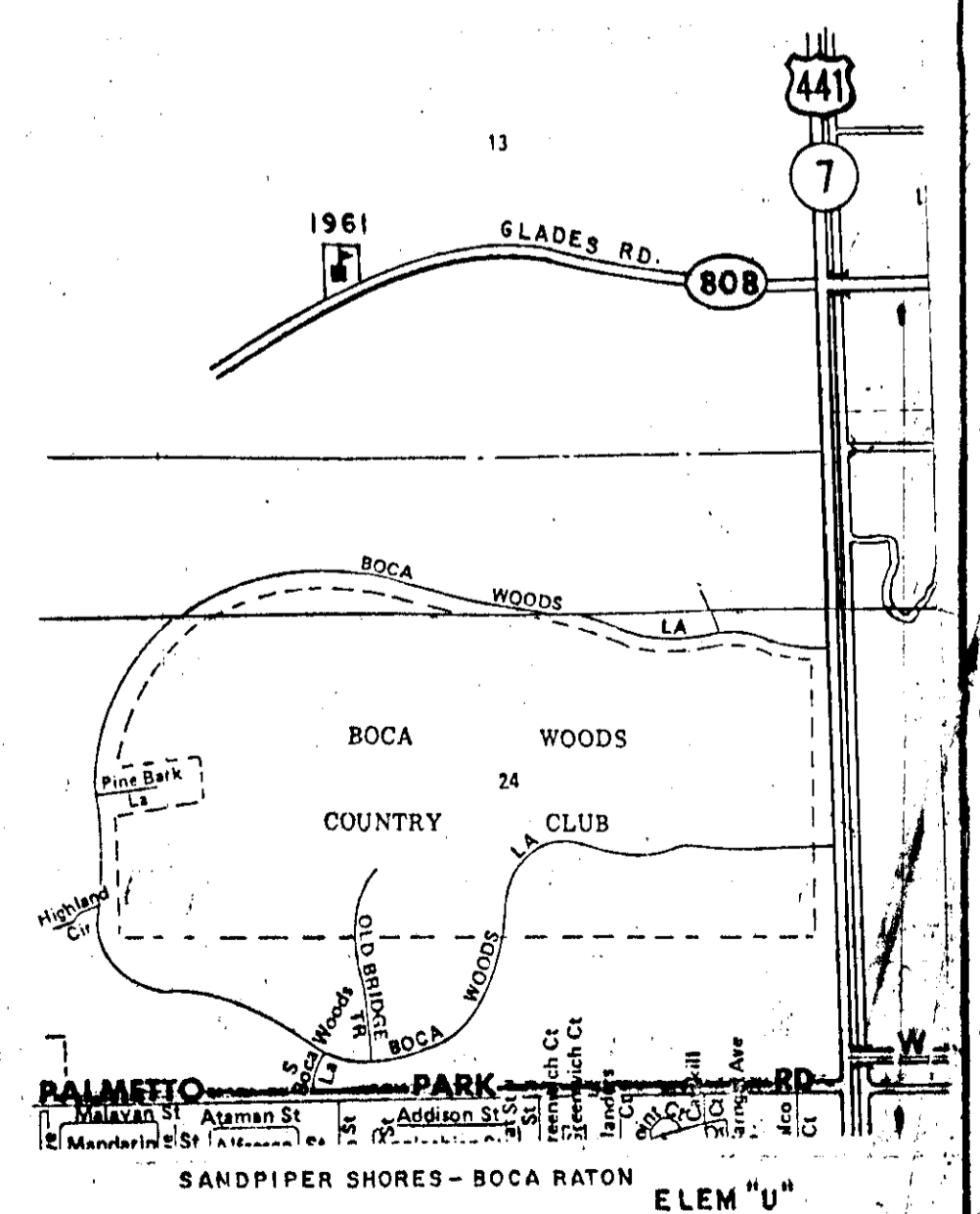

	REVISIONS ADDED NEW ACCESS DRIVE TO PARKING LOT 3-27-81	DATE 1-7-89	THE SCHOOL BOARD OF PALM BEACH COUNTY, FLORIDA FACILITY DESIGN ARCHITECT	TITLE MASTER SITE PLAN	SCHOOL SANDPIPER SHORES ELEMENTARY	SHEET 1	
	POW J.W.	DRWN BY J.W.		ARCHITECT	1961	BOCA RATON	2
	CHKD BY				JOB NO. 223		